

Music In Motion 2019

Home Show Day Rehearsal and Competition Information

Saturday, October 19th

2:00 p.m. – Meeting for all show helpers in the

P.V. Moore Cafeteria

Show Starts: 6:00 p.m.

Gates Open: 4:30 p.m.

Tickets: \$7.00 Pre-sale \$9.00 at the Gate

Central Square “Redhawk Regiment” Marching Band 2019

Schedule for the up-coming Home Show:

The Teacher’s Parking lot will be blocked off on Saturday. Everyone please park cars in the Millard Hawk lot for the day on Saturday starting at 12:00 noon. Do not park in front of the cafeteria, or around either loading docks so that these areas can be used for a warm-up area.

* **Band Members and Parents:** Parents and field band members: We are asking each student to bring in one to two dozen baked good items to be used in our bake sale for the Home Show. Please label your items and package them to be sold for fifty cents. The baked goods will be used for the judge’s room, hospitality, drivers and the directors of visiting schools. Thank you for your help.

Saturday, October 19th, 2019 - For rehearsal:

- Dress for the weather, but wear your Excellence shirts for rehearsal.
Bring a change of clothes if the weather appears to be inclement.
- Bring black socks, your grey uniform dry fit shirt for under uniforms, black gloves, shiny black band shoes, gauntlets and shorts to wear under the uniforms.
- **BE SURE TO EAT BREAKFAST BEFORE YOU ARRIVE.**
- **Saturday Rehearsal Schedule:**

- 11:00 a.m. – Load and move pit equipment to the stadium area.
- 11:15 a.m. - All Field Band members arrive.
- 11:45 a.m. – 3:30 p.m. - Rehearsal including final run
- 2:00 p.m. – Meeting in the Cafeteria for all Show Help
- 3:30 p.m. – Music Boosters provide food in cafeteria for band members. Eat and change into uniform.
- 5:00 p.m. - Area F will be available - Stretch, and Basics begins
Warm-up and ensemble space (West Genesee is in next at 7:03)
- 6:00 p.m. – Warm-up and Tuning
- 6:20 p.m. – Ensemble
- 6:35 p.m. – Load carts, circle and sing
- 6:45 p.m. – Move to staging area
- 6:55 p.m. – Arrive at the gate for staging.
- 7:05 p.m. - Central Square performs in competition.

Following the performance at the stadium equipment and instruments must be returned to the high school. Change out of uniform and then enter the stadium in time for Retreat and Awards. Seniors remain in uniform. Along with Drum Major Claire Ames the following seniors are also invited for Retreat: Tyler Jessie and Michelle Bedworth. For Senior Recognition all seniors must be in full uniform and must be with their parents at the track entrance area organizing to enter the stadium at 8:05 p.m.

8:25 p.m. - Senior Recognition: Seniors and their parents must be lined up ready to come onto the track immediately following the West Genesee High School band performance. The seniors and parents will move onto the track toward the 50 yard line. Parents line up behind your son or daughter. When the field band member's name is called, the field band member please take two steps forward to be recognized.

Drum Major Retreat and Awards:

As soon as Senior Recognition has ended, Drum Majors and those involved in Retreat move to the end zone area to join the other Drum Majors waiting to march onto the field for Awards.

Thank you to all who will be helping on Saturday to make the "Music In Motion" Home Show a great success!! Please call me if you have any questions.

Ron Haldeman,
Field Band Director

Ron Haldeman

668-4231 – CSSD Office
436-2825 – Cell

Central Square “Redhawk Regiment”
Presents
“Music In Motion” 2019

Date – October 19th, 2019

Time – 6:00 p.m.

Location – Central Square School District Stadium, Central Square, NY

Contest Schedule.....Star Spangled Banner 5:55 p.m.

Introduction of the Judges.....5:58 p.m.

<u>Class</u>	<u>Band</u>	<u>Staging Time</u>	<u>Performance Time</u>
Central Square District Stadium			
Announcements.....			5:52 p.m.
“Star Spangled Banner”.....			5:55 p.m.
“Introduction of Judges”.....			5:58 p.m.
“Bands Competing”			
	Marcus Whitman.....		6:00 p.m.
	Auburn.....		6:13 p.m.
	Phoenix.....		6:26 p.m.
	ES-M.....		6:39 p.m.
	New Hartford.....		6:52 p.m.
	Central Square.....		7:05 p.m.
Intermission(Judge’s Break).....7:18 p.m.			
	Liverpool.....		7:31 p.m.
	Baldwinsville.....		7:44 p.m.
	Victor.....		7:57 p.m.
	West Genesee.....		8:10 p.m.
Drum Majors:			
	Please form for “Retreat” at the south end of the end zone.....		8:25 p.m.
	Senior Recognition.....		8:25 p.m.
“Raffle Announcement”.....8:35 p.m.			
“Presentation of Awards”			
	Drum Major Retreat.....		8:45 p.m.

Central Square “Redhawk Regiment”
Presents: “Music In Motion” 2019

Date – October 19th, 2019

Time – 6:00 p.m.

Location – Central Square School District Stadium, Central Square, NY

Contest Schedule.....Star Spangled Banner 5:55 p.m.

Introduction of the Judges.....5:58 p.m.

The following schedule indicates time in a rehearsal area for each band. If you arrive earlier find areas to rehearse, but just respect the following schedule as band performance times approach. Thank you for your cooperation.

Band	Warm-up Area	Staging Time	Performance Time
Marcus Whitman	A 4:53-5:45 p.m.	5:55 p.m.	6:00 p.m.
Auburn	B 5:06.-5:58 p.m.	6:08 p.m.	6:13 p.m.
Phoenix	C 5:19-6:11 p.m.	6:21 p.m.	6:26 p.m.
ES-M	D 5:32-6:24 p.m.	6:34 p.m.	6:39 p.m.
New Hartford	E 5:45-6:37 p.m.	6:47 p.m.	6:52 p.m.
Central Square	F 5:58-6:50 p.m.	7:00 p.m.	7:05 p.m.
Intermission(Judge’s Break)			
Liverpool	C 6:24-7:16 p.m.	7:26 p.m.	7:31 p.m.
Baldwinsville	D 6:37-7:29 p.m.	7:39 p.m.	7:44 p.m.
Victor	E 6:50-7:42 p.m.	7:52 p.m.	7:57 p.m.
West Genesee	F 7:03-7:55 p.m.	8:05 p.m.	8:10 p.m.

***** See Map for Warm-up area, staging and performance entrance and exits.**

Drum Majors:

Please form for “Retreat” at the south end of the end zone 8:25 p.m.
 Senior Recognition 8:25 p.m.
 Presentation of Awards, Drum Major Retreat 8:45 p.m.
 Between the last performing band and the Drum Major Retreat, there will be Senior Recognition of the Central Square Band Seniors.

AED UNITS ARE AVAILABLE IN THE PRESS BOX AND OUTSIDE THE HIGH SCHOOL OFFICE.

The path to the field is a driveway from our practice field to the stadium. 4 Across is suggested. This is only recommended if you and your staff wish to alter this route feel free. Please do not hold up the contest. You may pick up your pit as you pass them. Or you can do as you please.

AED units available in the Press Box and outside high school OFFICE

Director's Map to Field

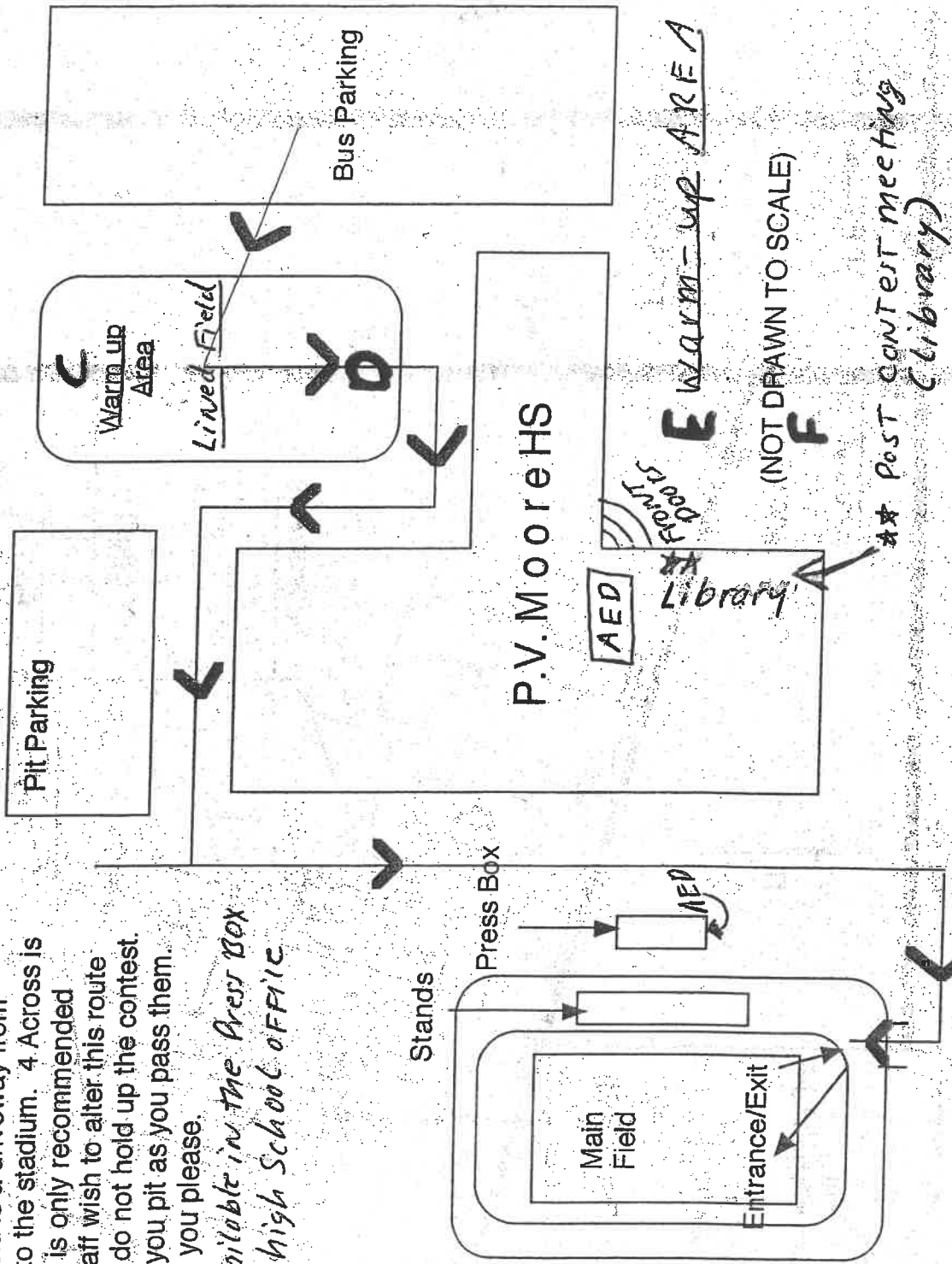

A (warm-up) B

Directors Map of the Central Square Campus

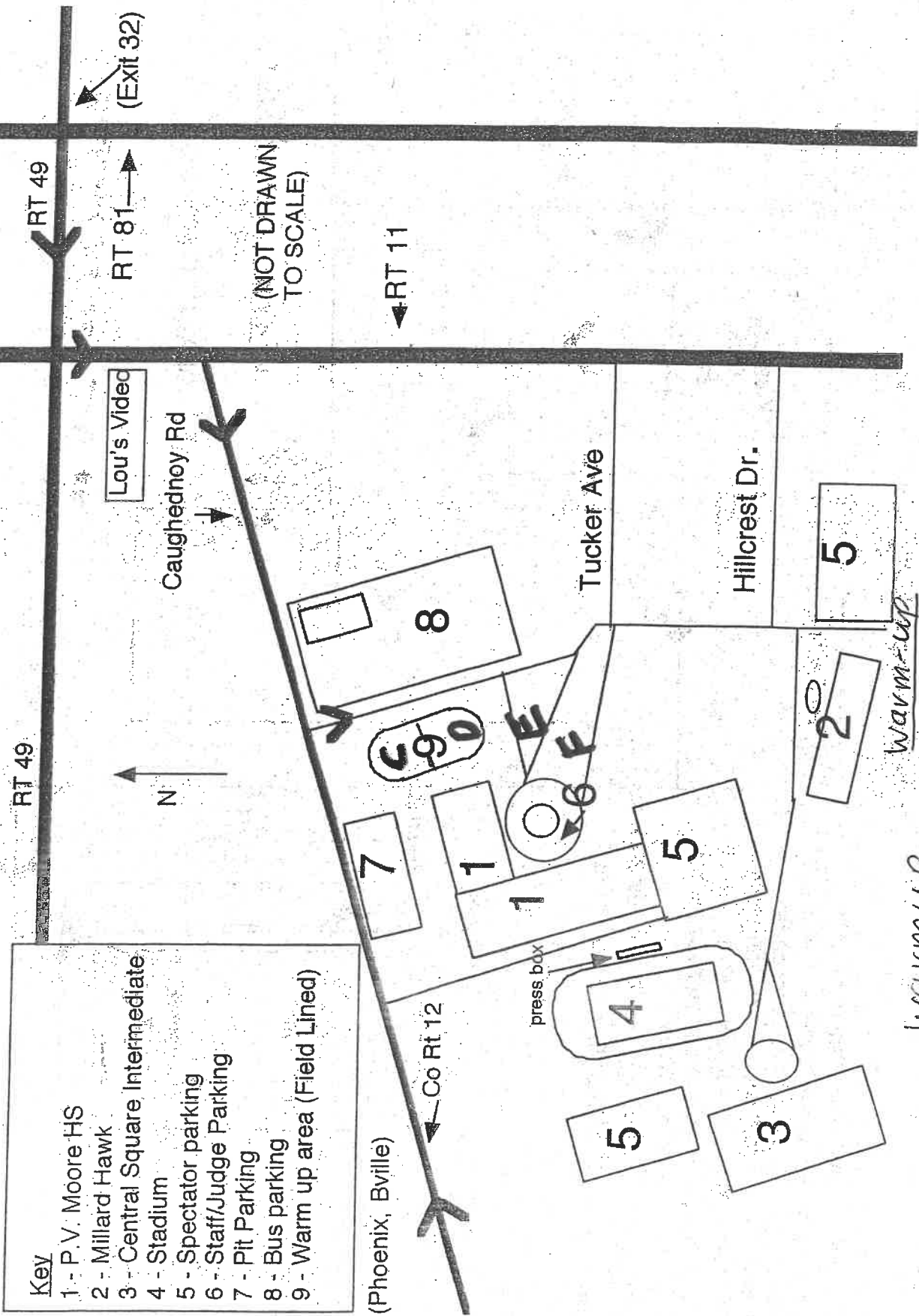

- Key**
- 1 - P. V. Moore HS
 - 2 - Millard Hawk
 - 3 - Central Square Intermediate
 - 4 - Stadium
 - 5 - Spectator parking
 - 6 - Staff/Judge Parking
 - 7 - Pit Parking
 - 8 - Bus parking
 - 9 - Warm up area (Field Lined)

(Phoenix, Bville)

warm-up
A

warm-up
B

Order Of Critique

Victor – 89 miles
Marcus Whitman – 83 miles
New Hartford – 60 miles
Auburn – 49 miles
West Genesee – 26 miles
East Syracuse - Minoa – 21 miles
Baldwinsville – 17 miles
Liverpool – 15 miles
Phoenix High School – 9 miles
Central Square High School – 0 miles